

LOOSEN NUTS AND SET BOLT.
REFE ON BOTTOM NUT TO ENSURE BEARING
HAS SEATED COMPLETELY. THEN TIGHTEN
DOWN SECOND NUT SO TWISTER TURNS
FREELY.

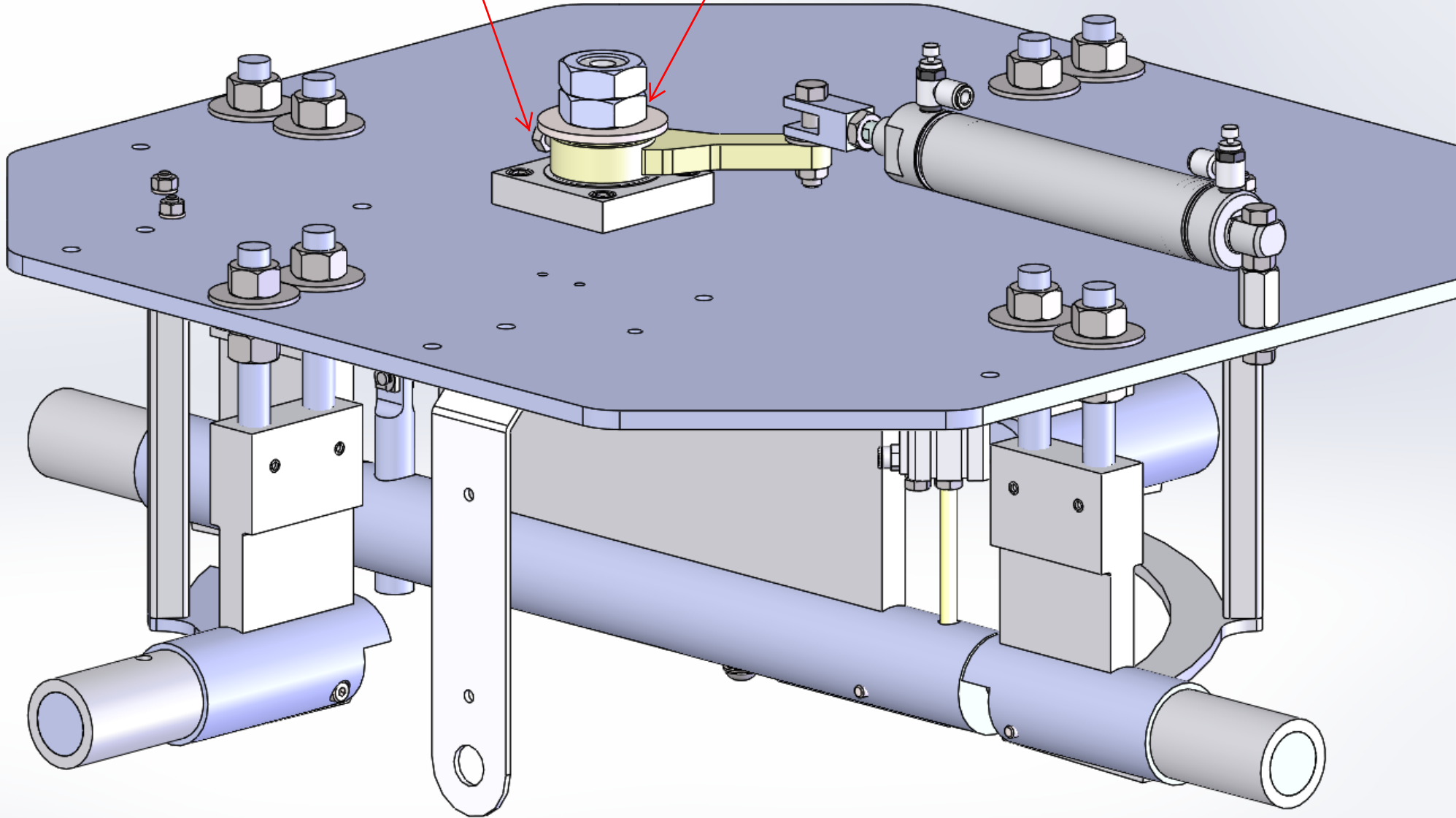

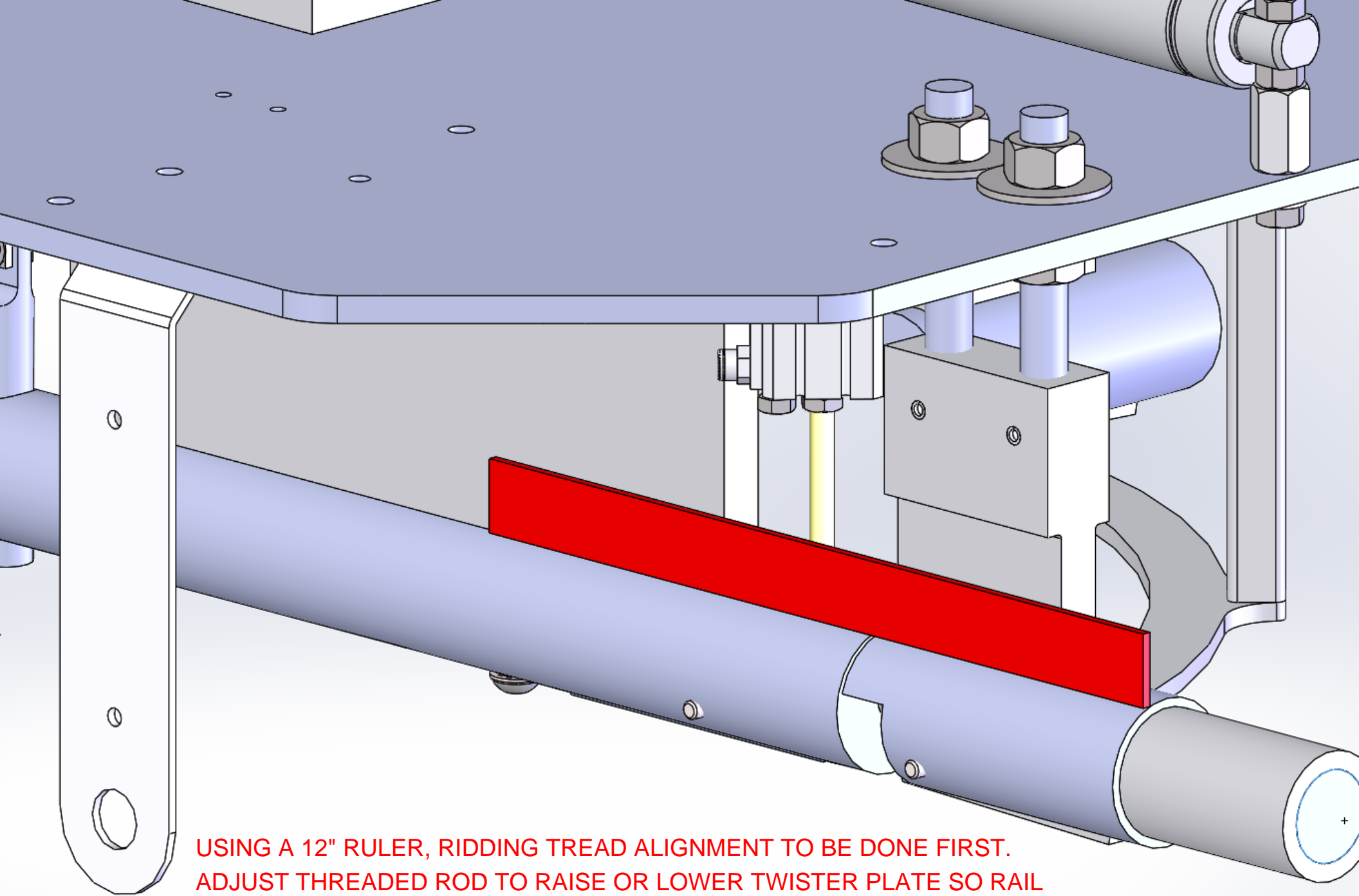

USING A 12" RULER, RIDDING TREAD ALIGNMENT TO BE DONE FIRST.
ADJUST THREADED ROD TO RAISE OR LOWER TWISTER PLATE SO RAIL
IS FLUSH OR SLIGHTLY FALLING OFF IN THE DIRECTION OF TRAVEL
ON ALL 4 JOINTS.

RULER TO BE FLUSH AGAINST BOTH BARS.

BOTH RAILS TO BE FLUSH AND LEVEL.

REMOVE STOP PIN TO ADJUST OPPOSITE END.

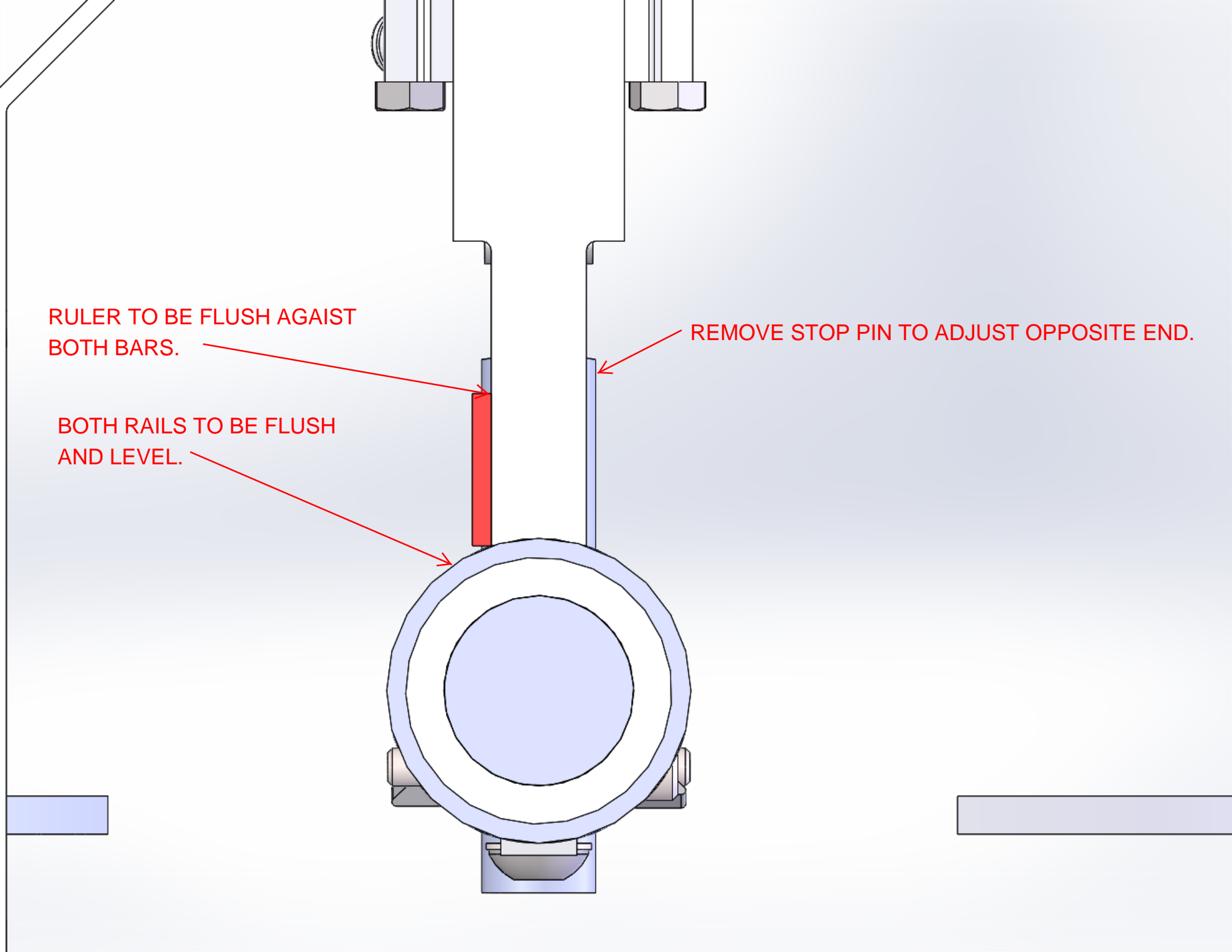

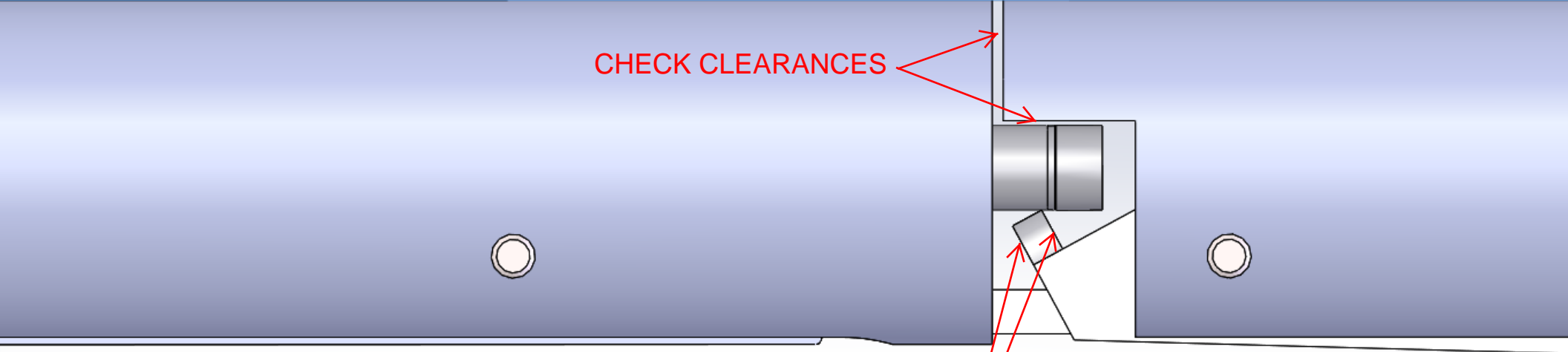
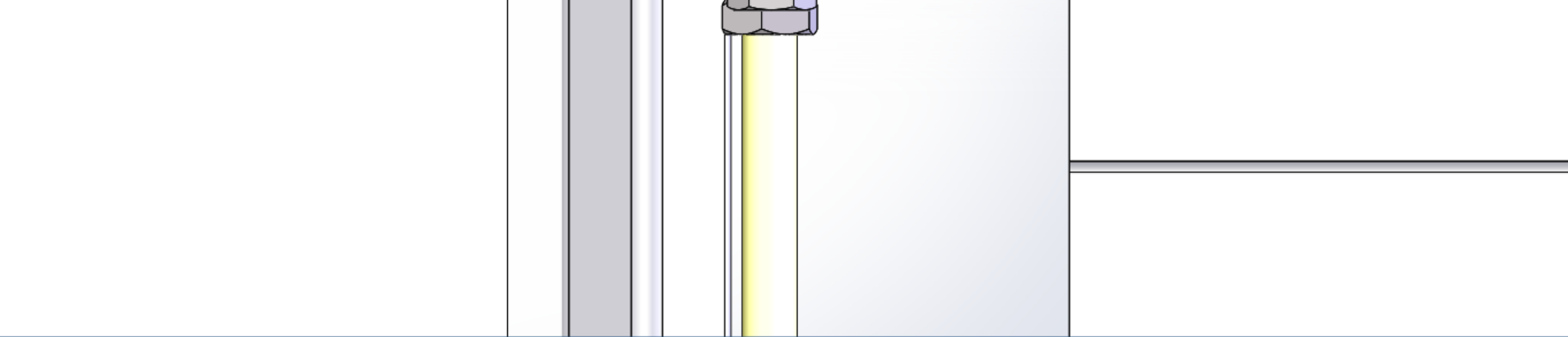

CHECK CLEARANCES

BEVEL BOTH EDGES OF RAMP
AND GREASE

BOTH PIECES OF RAIL PARALEL TO RULER

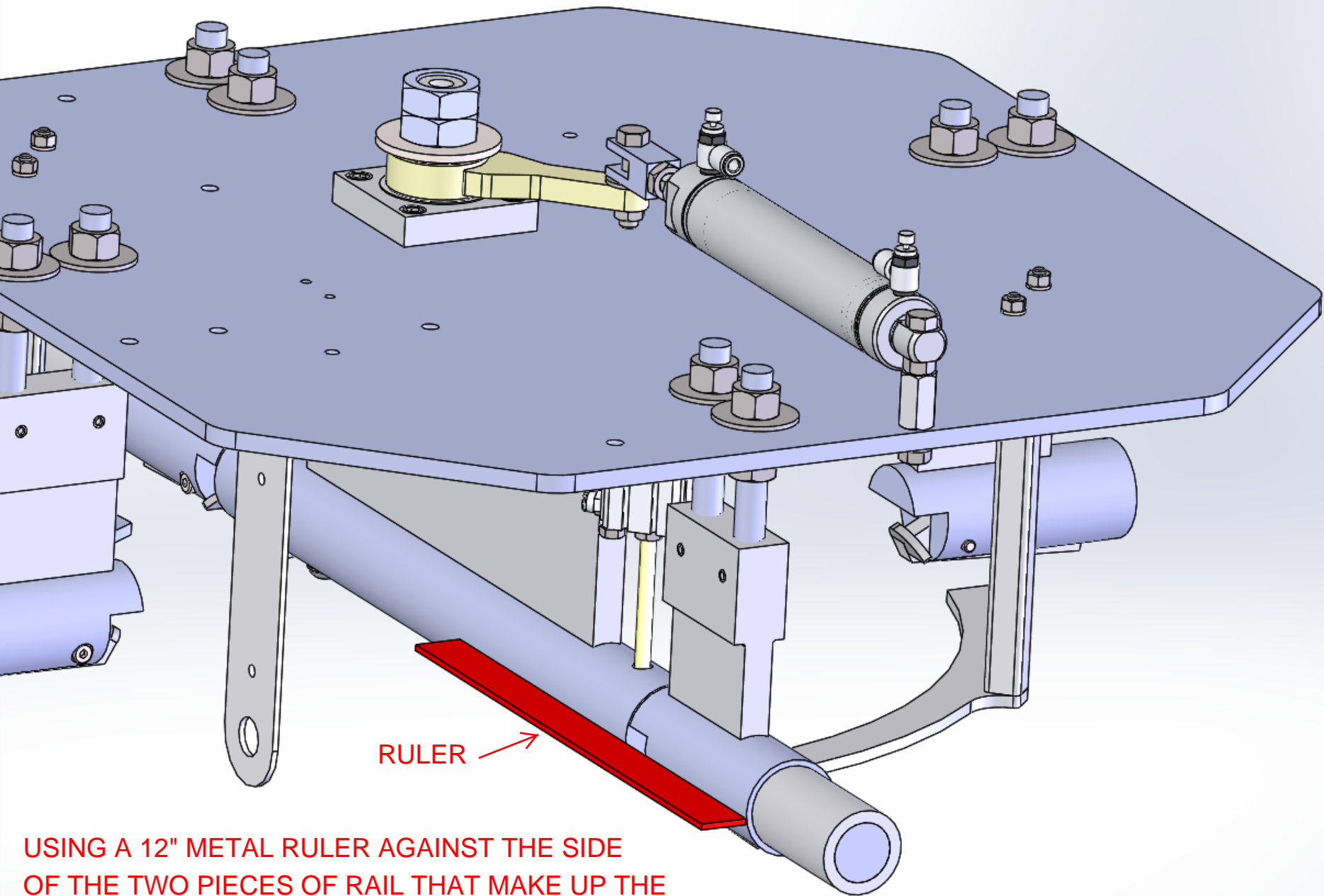

RULER →

USING A 12" METAL RULER AGAINST THE SIDE OF THE TWO PIECES OF RAIL THAT MAKE UP THE JOINT, ADJUST THE SET BOLT SO ALIGNMENT IS FLUSH.

ALL 4 JOINTS TO BE ADJUSTED.
YOU WILL HAVE TO FIND A
MEDIUM BETWEEN THE 3
PIECES OF RAIL.

